

DONOVAN PART #	PARTS PER SYSTEM	BALLOON LETTER	DESCRIPTION
7200UK	1	A	SKIP SHEETING SYSTEM (W/O HYDRAULIC KIT)
7213	2	B	PIVOT ARM RESTS (without rubber bumper)
7210	4	C	PIVOT MOUNT ASSEMBLIES
2744	2	D	PIN - 75 MM LONG
7211	2	E	LOWER ARM WELDMENT
2733	6	F	PIN - 70 MM LONG
2760	1	G	UPPER ARM WELDMENT - RIGHT
2769	1	H	TARP ATTACHMENT BAR
2755	1	I	CROSS TUBE WELDMENT
2762	1	J	ROLLER BAR ASSY.
2731	1	K	ROLLER CRADLE
2756	2	L	TOWER LEG WELDMENT
2758	1	M	UPPER ARM WELDMENT - LEFT
2735	10	N	LOCK RING - SHORT
2763	2	O	1 1/2" BORE, UPPER HYDRAULIC CYLINDER
7212	2	P	LOCK RING - LONG
2768	2	Q	2" BORE, LOWER HYDRAULIC CYLINDER
2391	2	R	RUBBER REAR STOP 4 7/8" X 1 3/4"

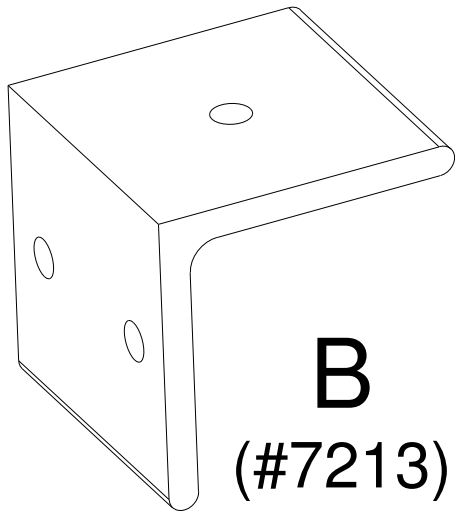

**B**  
(#7213)

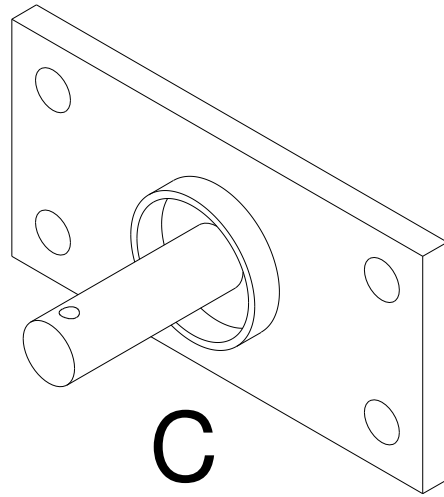

**C**  
(#7210)

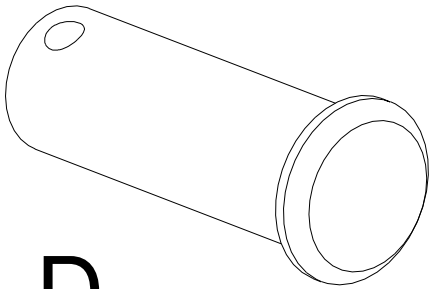

**D**  
(#2744)

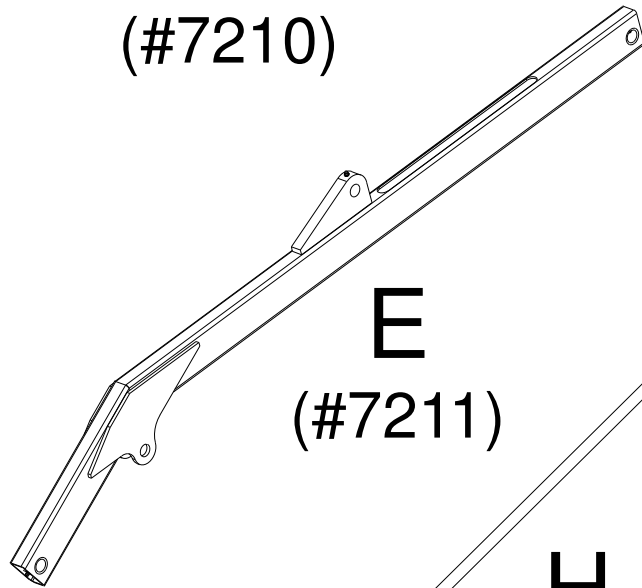

**E**  
(#7211)

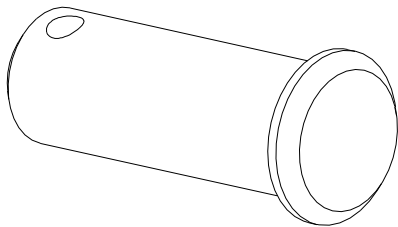

**F**  
(#2733)

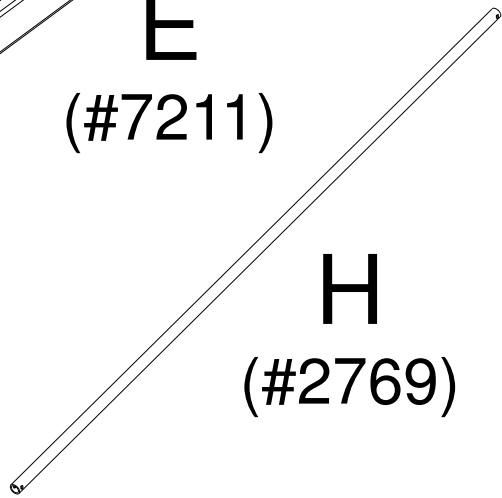

**H**  
(#2769)

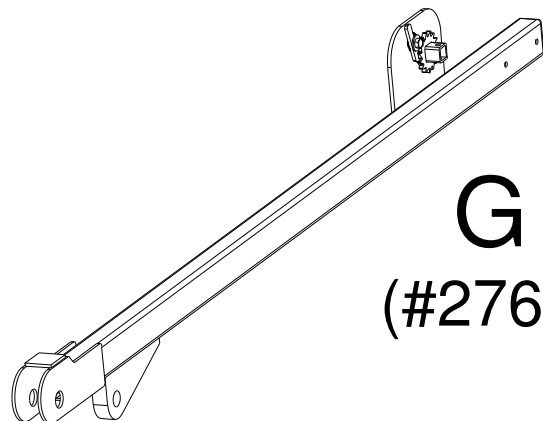

**G**  
(#2760)

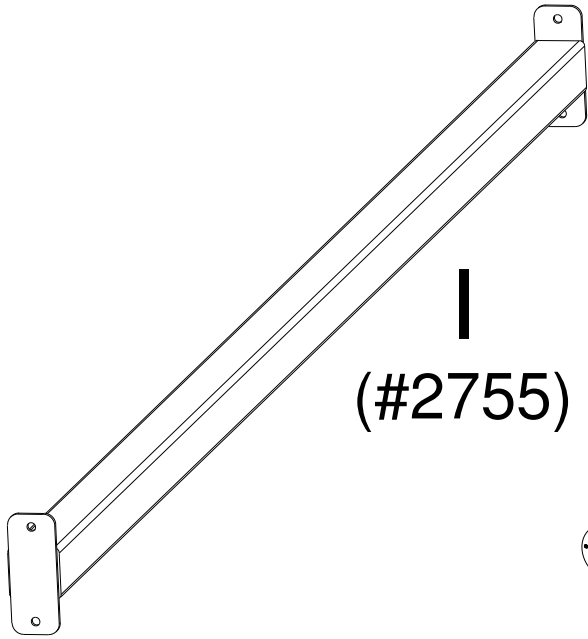

**I**  
**(#2755)**

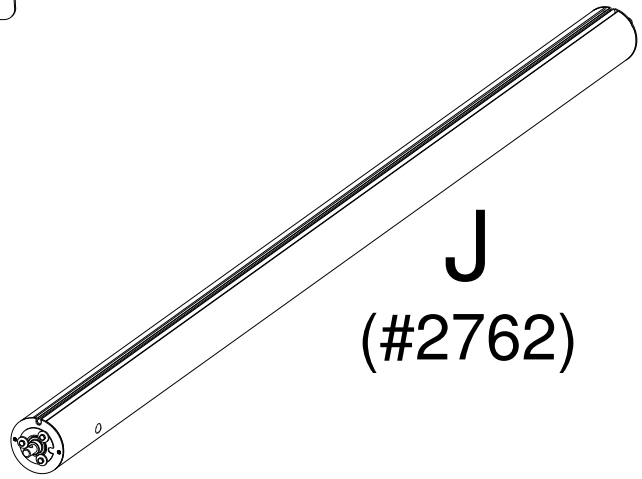

**J**  
**(#2762)**

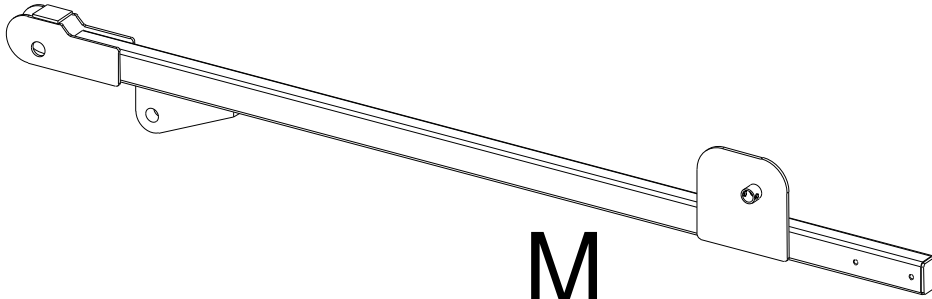

**M**  
**(#2758)**

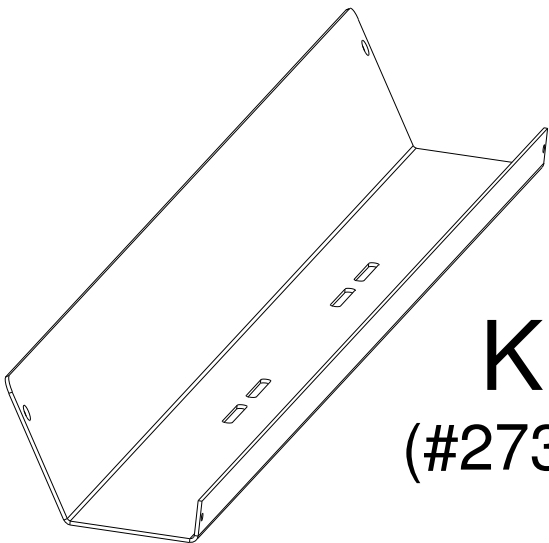

**K**  
**(#2731)**

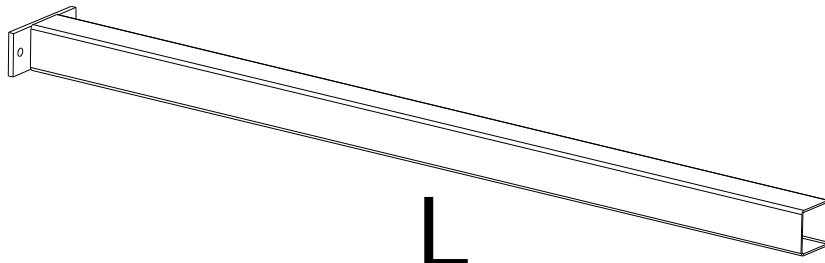

**L**  
(#2756)

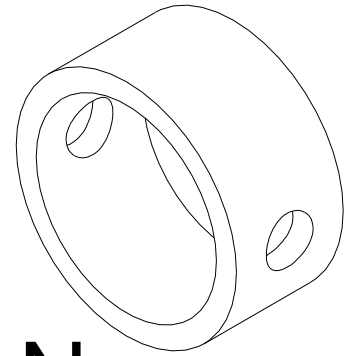

**N**  
(#2735)

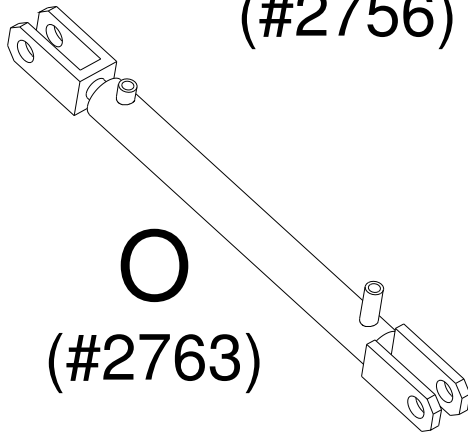

**O**  
(#2763)

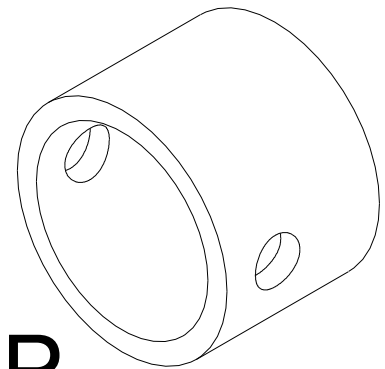

**P**  
(#7212)

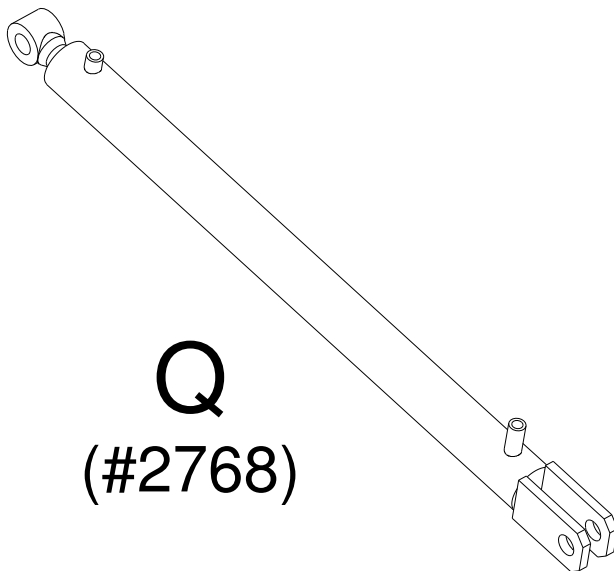

**Q**  
(#2768)